



606'

735'

600'

- Property Line
- Buildings
- ▬ Driveway
- ▬ Parking
- ▬ Yard/corral
- ✱ Fence
- ▬ Ceremony/Reception/gathering area
- ✱ Porta Potty
- ▬ County Road
- Treed Area

10,500 sq ft

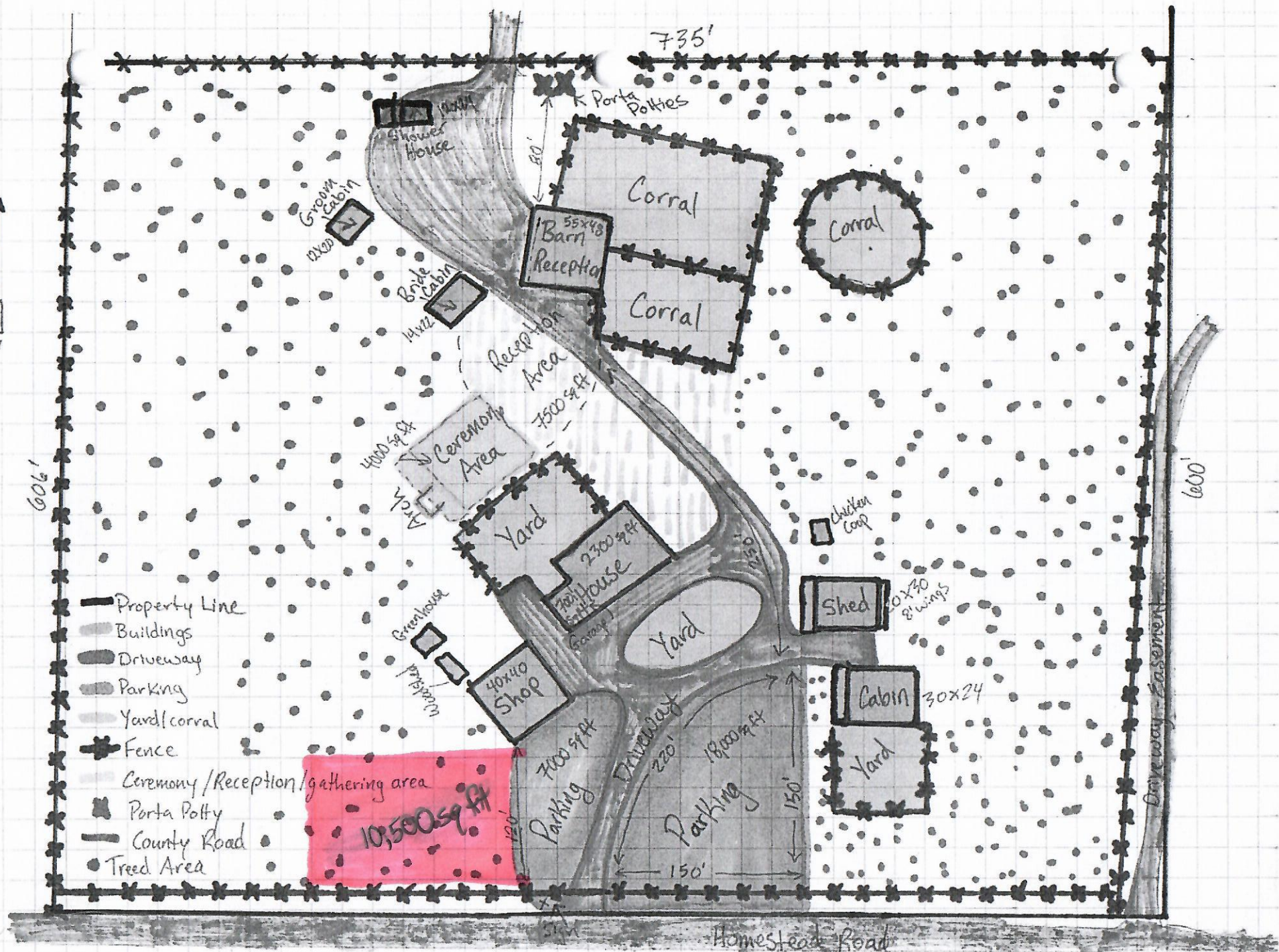

735'

Parcel RP54N03W333530A