

298 RED CEDAR LANE SITE PLAN

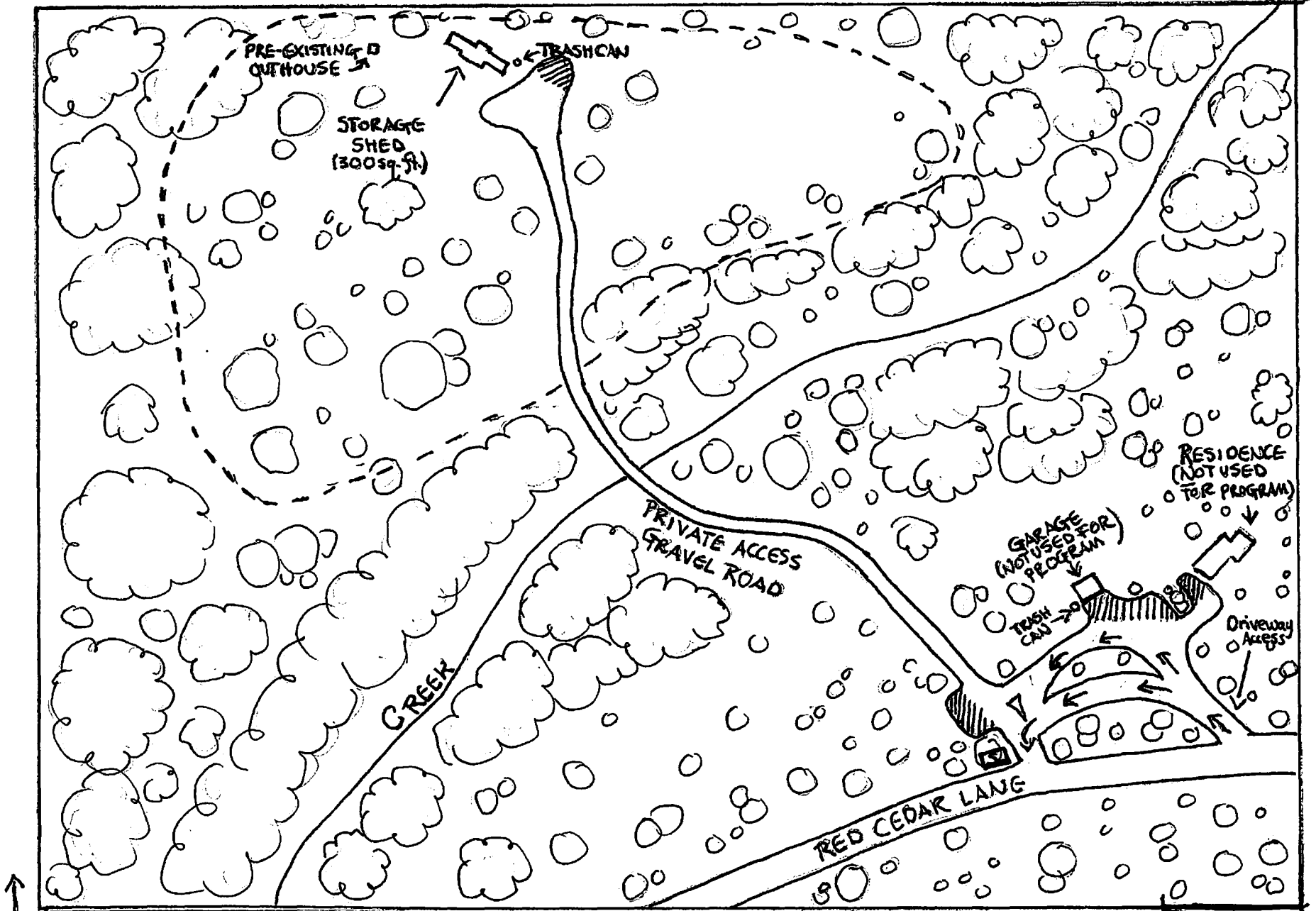

Revised Site Plan
Received 2.3.26

APPROVED 4/22/2026



SUBJECT PROPERTY BOUNDARY
(15 ACRES)

KEY

- - - - = GENERAL OUTDOOR EDUCATION AREA
-  = PARKING AREAS
-  = TREES / FORESTED AREA
-  SIGN - NTS ONLY ON PROGRAM DAYS

SCALE
1" = 100'

